

FEATURES

- Variable flow, proportional to the control signal
- Valves do not require a minimum operating pressure
- Valves can be mounted in any position
- The solenoid valves satisfy all relevant EC directives

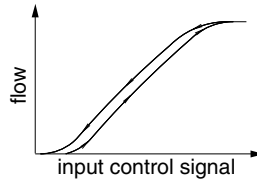

GENERAL

Differential pressure See «SPECIFICATIONS» [1 bar = 100 kPa]
Maximum viscosity 21 cSt (mm²/s)

| fluids (*) | temperature range (TS) (2) | seal materials (*) |
|----------------------------|----------------------------|-----------------------|
| air, inert gas, water, oil | - 10°C to + 90°C | FPM (fluoroelastomer) |

MATERIALS IN CONTACT WITH FLUID

(*) Ensure that the compatibility of the fluids in contact with the materials is verified

| | Brass body | Stainless steel body |
|------------------|-----------------|----------------------|
| Body | Brass | AISI 303 SS |
| Core tube | Stainless steel | Stainless steel |
| Core and plugnut | Stainless steel | Stainless steel |
| Springs | Stainless steel | Stainless steel |
| Riderring | PTFE | PTFE |
| Seat | Brass | Stainless steel |
| Seal, disc | FPM | FPM |
| Breaker piece | Stainless steel | Stainless steel |

ELECTRICAL CHARACTERISTICS

Coil insulation class F
Connector Spade plug (cable Ø 6-10 mm)
Connector specification ISO 4400 / EN 175301-803, form A
Electrical safety IEC 335
Electrical enclosure protection Moulded IP65 (EN 60529)
Standard voltages DC (=) : 24V (Other voltages on request)

| prefix option | operating current (mA) | power ratings | | | | operator ambient temperature range (TS) (2) (°C) | replacement coil (=) | type (1) |
|---------------|------------------------|---------------|----------------|----------------|--------|--|-----------------------|----------|
| | | inrush ~ (VA) | holding ~ (VA) | hot/cold = (W) | = (W) | | | |
| SC | 100 - 500 | - | - | - | 11 / 8 | -10 to + 75 | 24 V DC 400429-040 | 01 |

Voltage regulation

0 - 24 V DC
24 V DC pulse width modulated (300 Hz)

Flow regulation characteristics (3)

Hysteresis < 5% ; Repeatability < 3% ; Sensitivity < 2%

SPECIFICATIONS

| pipe size | orifice size (mm) | flow coefficient Kv (m ³ /h) (l/min) | operating pressure differential (bar) | | | | power coil (W) | catalogue number | | | | options | | | |
|-----------------------------|-------------------|---|---------------------------------------|-----------|---------------------|---|----------------|------------------|-------------|---------------------|-------------|-------------|----|-------|---|
| | | | min. | max. (PS) | | | | brass (=) | | stainless steel (=) | | EPDM | CR | P.TEE | |
| | | | | vacuum | air, water, oil (*) | = | | air / inert gas | liquids | air / inert gas | liquids | | | | |
| NC - Normally closed | | | | | | | | | | | | | | | |
| 1/4 | G | 1,2 | 0,05 | 0,8 | 0 | 1 | 16 | 8 | SCG202A001V | SCG202A051V | - | - | E | J | T |
| | NPT | 1,2 | 0,05 | 0,8 | 0 | 1 | 16 | 8 | - | - | SCB202A011V | SCB202A061V | E | J | T |
| | G | 2,4 | 0,12 | 2 | 0 | 1 | 8 | 8 | SCG202A002V | SCG202A052V | - | - | E | J | T |
| | NPT | 2,4 | 0,12 | 2 | 0 | 1 | 8 | 8 | - | - | SCB202A012V | SCB202A062V | E | J | T |
| | G | 3,2 | 0,24 | 4,0 | 0 | 1 | 4 | 8 | SCG202A003V | SCG202A053V | - | - | E | J | T |
| | NPT | 3,2 | 0,24 | 4,0 | 0 | 1 | 4 | 8 | - | - | SCB202A013V | SCB202A063V | E | J | T |
| | G | 4,0 | 0,42 | 7,0 | 0 | 1 | 2,5 | 8 | SCG202A004V | SCG202A054V | - | - | E | J | T |
| | NPT | 4,0 | 0,42 | 7,0 | 0 | 1 | 2,5 | 8 | - | - | SCB202A014V | SCB202A064V | E | J | T |
| 3/8 | G | 5,6 | 0,72 | 12,0 | 0 | 1 | 1,4 | 8 | SCG202A006V | SCG202A056V | - | - | E | J | T |
| | NPT | 5,6 | 0,72 | 12,0 | 0 | 1 | 1,4 | 8 | - | - | SCB202A016V | SCB202A066V | E | J | T |
| | G | 7,1 | 0,90 | 15,0 | 0 | 1 | 1 | 8 | SCG202A007V | SCG202A057V | - | - | E | J | T |
| | NPT | 7,1 | 0,90 | 15,0 | 0 | 1 | 1 | 8 | - | - | SCB202A017V | SCB202A067V | E | J | T |
| | Rp | 3,2 | 0,24 | 4,0 | 0 | 1 | 4 | 8 | SCE202A023V | SCE202A073V | - | - | E | J | T |
| | NPT | 3,2 | 0,24 | 4,0 | 0 | 1 | 4 | 8 | - | - | SCB202A033V | SCB202A083V | E | J | T |
| | Rp | 4,0 | 0,42 | 7,0 | 0 | 1 | 2,5 | 8 | SCE202A024V | SCE202A074V | - | - | E | J | T |
| | NPT | 4,0 | 0,42 | 7,0 | 0 | 1 | 2,5 | 8 | - | - | SCB202A034V | SCB202A084V | E | J | T |
| 3/8 | Rp | 5,6 | 0,72 | 12,0 | 0 | 1 | 1,4 | 8 | SCE202A026V | SCE202A076V | - | - | E | J | T |
| | NPT | 5,6 | 0,72 | 12,0 | 0 | 1 | 1,4 | 8 | - | - | SCB202A036V | SCB202A086V | E | J | T |
| | Rp | 7,1 | 0,90 | 15,0 | 0 | 1 | 1 | 8 | SCE202A027V | SCE202A077V | - | - | E | J | T |
| | NPT | 7,1 | 0,90 | 15,0 | 0 | 1 | 1 | 8 | - | - | SCB202A037V | SCB202A087V | E | J | T |

(1) Refer to the dimensional drawings on the following page.
(2) Damage may occur when liquids solidify above the specified minimum temperature.
(3) Percentage of max. value with 24 V DC, P.W.M. 300 Hz, supply at constant differential pressure.

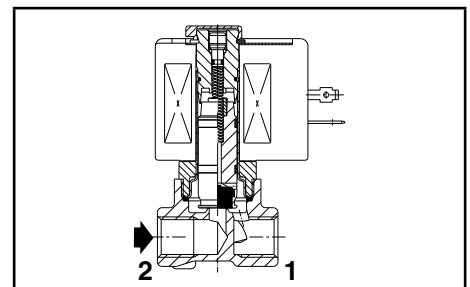
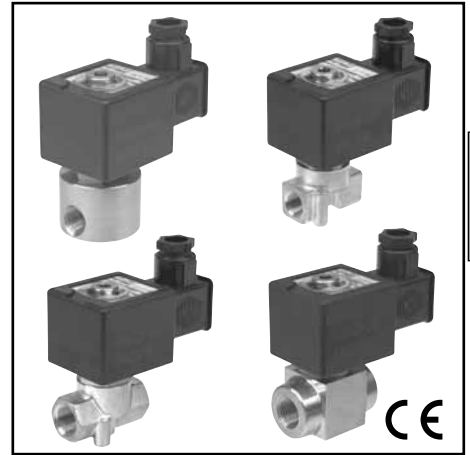

1/4 (brass body)

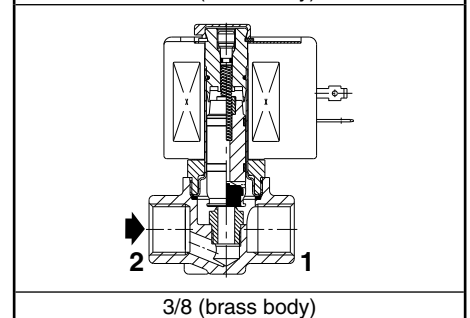

3/8 (brass body)

OPTIONS

- Valves can also be supplied with NBR (nitrile), EPDM (ethylene-propylene), CR (chloroprene / neoprene) and PTFE seals and discs
- Waterproof enclosure with embedded screw terminal coil according to protection class IP67, CEE-10
- Explosionproof enclosures for use in zones 1/21-2/22, categories 2-3 to ATEX Directive 94/9/EC, on request
- Electrical enclosures according to "NEMA" standards are available
- Mounting brackets
- Electronic proportional control unit (catalogue number: **E908A001**, see V150)
Features:
 - analog input control signals: 0 - 10 V DC, 0 - 20 mA or 4 - 20 mA
 - coil current (= flow rate) adjustable to required control signals
 - switch-off function at less than 2% of the maximum control function
 - adjustable ramp control
 - adjustable frequency
 - output current independent of coil resistance and supply voltage variations
 - housed in: a box with spade plug connector according to ISO 4400 / IP65
- Other pipe connections are available on request

INSTALLATION

- The solenoid valves can be mounted in any position without affecting operation
- Brass and NPT 3/8 stainless steel solenoid valves have 2 mounting holes in body
- NPT 1/4 stainless steel valves are standard supplied with mounting brackets
- Threaded pipe connection is standard: E = Rp (ISO 7/1) ; G = G (ISO 228/1) ; B = NPT (ANSI 1.20.3)
- Installation/maintenance instructions are included with each valve

ORDERING EXAMPLES:

| | | | | | | |
|--------|-------------|--------------|---|-----|---|----------|
| SC | G | 202 | A | 001 | V | 24V / DC |
| SC | B | 202 | A | 011 | V | 24V / DC |
| prefix | pipe thread | basic number | | | | voltage |
| | | | | | | suffix |

DIMENSIONS (mm), WEIGHT (kg)



TYPE 01
Prefix "SC" Solenoid
Epoxy moulded
IEC 335 / ISO 4400
IP65

SCG202A001V/002V/003V/004V/006V/007V
SCB202A051V/052V/053V/054V/056V/057V

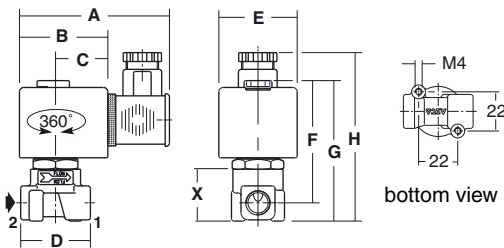

SCE202A023V/024V/026V/027V
SCE202A073V/074V/076V/077V

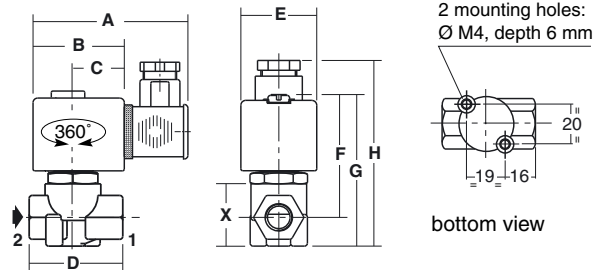

SCG202A011V/012V/013V/014V/016V/017V
SCB202A061V/062V/063V/064V/066V/067V

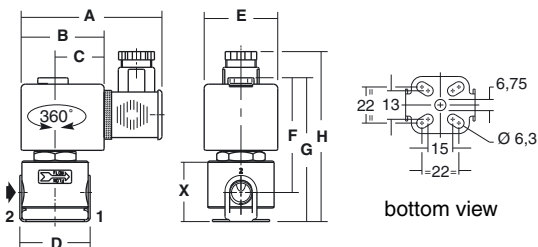

SCB202A033V/034V/036V/037V
SCB202A083V/084V/086V/087V

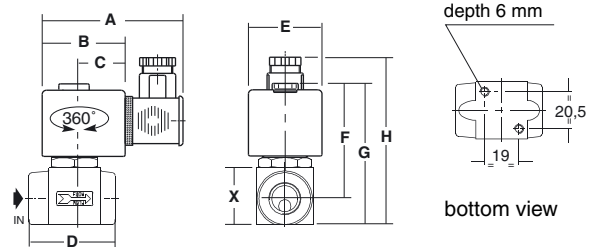

| type | prefix option | catalogue number | A | B | C | D | E | F | G | H | X | weight ⁽¹⁾ |
|------|---------------|--|----|----|----|----|----|----|----|----|----|-----------------------|
| 01 | SC | SCG202A001V/002V/003V/004V/006V/007V/051V/052V/053V/054V/056V/057V | 85 | 50 | 30 | 40 | 45 | 68 | 79 | 95 | 30 | 0,50 |
| | | SCG202A011V/012V/013V/014V/016V/017V/061V/062V/063V/064V/066V/067V | 80 | 50 | 30 | 42 | 45 | 60 | 79 | 95 | 37 | 0,60 |
| | | SCE202A023V/024V/026V/027V/073V/074V/076V/077V | 80 | 50 | 30 | 48 | 45 | 68 | 82 | 97 | 32 | 0,50 |
| | | SCB202A033V/034V/036V/037V/083V/084V/086V/087V | 80 | 50 | 30 | 51 | 45 | 68 | 81 | 97 | 31 | 0,65 |

⁽¹⁾ including coil and connector.